



Operating Instructions Home Theater Audio System

Model No. **SC-HT40**

Dear customer

Thank you for purchasing this product.
Please read these instructions carefully before connecting,
operating or adjusting this product.
Please keep this manual for future reference.

Table of contents

Before use

IMPORTANT SAFETY INSTRUCTIONS	2
Supplied accessories	3
Listening caution	3
The remote control	3

Step 1

Speaker setup
4

Step 2

Home theater connections
6

Step 3

Antenna and AC power supply connections
7

Step 4

Settings
8

Operations

Basic operations	10
Control guide	11
Making a recording	13
The RESET function	13
MENU operation	14
The radio	15
Sound field	16
Other functions	17
Other settings	18
Remote control operation guide	19
Product service	20

Reference

Specifications	21
Warranty (U.S.A.)	22
Warranty (Canada)	23
Troubleshooting guide	Back cover
Maintenance	Back cover



As an ENERGY STAR® Partner¹,
Panasonic has determined that this
product meets the ENERGY STAR®
guidelines for energy efficiency.

¹For Canada only: The word "Participant" is used in place of the word "Partner".

If you have any questions, contact 1-800-211-PANA (7262) in the U.S.A. or 1-800-561-5505 in Canada.

IMPORTANT SAFETY INSTRUCTIONS

Read these operating instructions carefully before using the unit. Follow the safety instructions on the unit and the applicable safety instructions listed below. Keep these operating instructions handy for future reference.

- 1) Read these instructions.
- 2) Keep these instructions.
- 3) Heed all warnings.
- 4) Follow all instructions.
- 5) Do not use this apparatus near water.
- 6) Clean only with dry cloth.
- 7) Do not block any ventilation openings. Install in accordance with the manufacturer's instructions.
- 8) Do not install near any heat sources such as radiators, heat registers, stoves, or other apparatus (including amplifiers) that produce heat.
- 9) Do not defeat the safety purpose of the polarized or grounding-type plug. A polarized plug has two blades with one wider than the other. A grounding-type plug has two blades and a third grounding prong. The wide blade or the third prong are provided for your safety. If the provided plug does not fit into your outlet, consult an electrician for replacement of the obsolete outlet.
- 10) Protect the power cord from being walked on or pinched particularly at plugs, convenience receptacles, and the point where they exit from the apparatus.
- 11) Only use attachments/accessories specified by the manufacturer.
- 12) Use only with the cart, stand, tripod, bracket, or table specified by the manufacturer, or sold with the apparatus. When a cart is used, use caution when moving the cart/apparatus combination to avoid injury from tip-over.
- 13) Unplug this apparatus during lightning storms or when unused for long periods of time.
- 14) Refer all servicing to qualified service personnel. Servicing is required when the apparatus has been damaged in any way, such as power-supply cord or plug is damaged, liquid has been spilled or objects have fallen into the apparatus, the apparatus has been exposed to rain or moisture, does not operate normally, or has been dropped.



IMPORTANT SAFETY INSTRUCTIONS



CAUTION: TO REDUCE THE RISK OF ELECTRIC SHOCK, DO NOT REMOVE SCREWS. NO USER-SERVICEABLE PARTS INSIDE. REFER SERVICING TO QUALIFIED SERVICE PERSONNEL.



The lightning flash with arrowhead symbol, within an equilateral triangle, is intended to alert the user to the presence of uninsulated "dangerous voltage" within the product's enclosure that may be of sufficient magnitude to constitute a risk of electric shock to persons.



The exclamation point within an equilateral triangle is intended to alert the user to the presence of important operating and maintenance (servicing) instructions in the literature accompanying the appliance.

WARNING:
TO REDUCE THE RISK OF FIRE, ELECTRIC SHOCK OR PRODUCT DAMAGE, DO NOT EXPOSE THIS APPARATUS TO RAIN, MOISTURE, DRIPPING OR SPLASHING AND THAT NO OBJECTS FILLED WITH LIQUIDS, SUCH AS VASES, SHALL BE PLACED ON THE APPARATUS.

The socket outlet shall be installed near the equipment and easily accessible or the mains plug or an appliance coupler shall remain readily operable.

THE FOLLOWING APPLIES ONLY IN THE U.S.A.

FCC Note:

This equipment has been tested and found to comply with the limits for a Class B digital device, pursuant to Part 15 of the FCC Rules.

These limits are designed to provide reasonable protection against harmful interference in a residential installation. This equipment generates, uses and can radiate radio frequency energy and, if not installed and used in accordance with the instructions, may cause harmful interference to radio communications. However, there is no guarantee that interference will not occur in a particular installation. If this equipment does cause harmful interference to radio or television reception, which can be determined by turning the equipment off and on, the user is encouraged to try to correct the interference by one or more of the following measures:

- Reorient or relocate the receiving antenna.
- Increase the separation between the equipment and receiver.
- Connect the equipment into an outlet on a circuit different from that to which the receiver is connected.
- Consult the dealer or an experienced radio/TV technician for help.

Any unauthorized changes or modifications to this equipment would void the user's authority to operate this device.

This device complies with Part 15 of the FCC Rules. Operation is subject to the following two conditions: (1) This device may not cause harmful interference, and (2) this device must accept any interference received, including interference that may cause undesired operation.

Responsible Party:
Panasonic Corporation of North America
One Panasonic Way
Secaucus, NJ 07094
Telephone No.: 1-800-211-7262

System	SC-HT40
AV Control Receiver	SA-HT40
Front speakers	SB-PF40
Surround speakers	SB-PS40
Center speaker	SB-PC40
Subwoofer	SB-W40

Supplied accessories

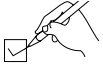

Please check and identify the supplied accessories.

- | | |
|--|--|
| <input type="checkbox"/> 1 AC power supply cord (K2CB2CB00018) | <input type="checkbox"/> 1 FM indoor antenna (RSA0007-L) |
| <input type="checkbox"/> 1 AM loop antenna (N1DAAA000002) | <input type="checkbox"/> 1 Remote control (N2QAYB000009) |
| <input type="checkbox"/> 2 Batteries | <input type="checkbox"/> 1 speaker sticker sheet (RQCAV0006) |

Use the numbers indicated in parentheses when asking for replacement parts. (As of January 2006)

In the U.S.A. : To order accessories, refer to “Accessory Purchases” on page 22.

In Canada : To order accessories, call the dealer from whom you have made your purchase.

Listening caution



Selecting fine audio equipment such as the unit you've just purchased is only the start of your musical enjoyment. Now it's time to consider how you can maximize the fun and excitement your equipment offers. This manufacturer and the Electronic Industries Association's Consumer Electronics Group want you to get the most out of your equipment by playing it at a safe level. One that lets the sound come through loud and clear without annoying blaring or distortion-and, most importantly, without affecting your sensitive hearing.

We recommend that you avoid prolonged exposure to excessive noise.

Sound can be deceiving. Over time your hearing “comfort level” adapts to higher volumes of sound. So what sounds “normal” can actually be loud and harmful to your hearing.

Guard against this by setting your equipment at a safe level BEFORE your hearing adapts.

To establish a safe level:

- Start your volume control at a low setting.
- Slowly increase the sound until you can hear it comfortably and clearly, and without distortion.

Once you have established a comfortable sound level:

- Set the dial and leave it there.

Taking a minute to do this now will help to prevent hearing damage or loss in the future. After all, we want you listening for a lifetime.

CAUTION!

DO NOT INSTALL OR PLACE THIS UNIT IN A BOOKCASE, BUILT-IN CABINET OR IN ANOTHER CONFINED SPACE. ENSURE THE UNIT IS WELL VENTILATED. TO PREVENT RISK OF ELECTRIC SHOCK OR FIRE HAZARD DUE TO OVERHEATING, ENSURE THAT CURTAINS AND ANY OTHER MATERIALS DO NOT OBSTRUCT THE VENTILATION VENTS.

CAUTION!

Do not place anything on top of this unit or block the heat radiation vents in any way. In particular, do not place tape decks or CD/DVD players on this unit as heat radiated from it can damage your software.

If you see this symbol-

Information on Disposal in other Countries outside the European Union



This symbol is only valid in the European Union. If you wish to discard this product, please contact your local authorities or dealer and ask for the correct method of disposal.

The remote control

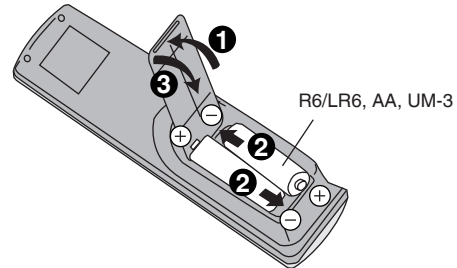

- Insert so the poles (+ and -) match those in the remote control.
- Do not use rechargeable type batteries.

Use

Aim at the sensor, avoiding obstacles, at a maximum range of 7 m (23 feet) directly in front of the unit.

Remote control signal sensor

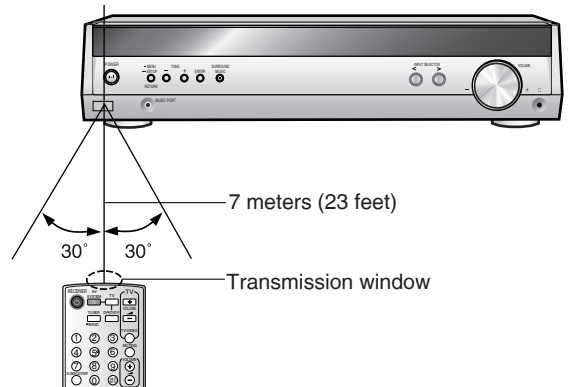

Note

- Keep the transmission window and the unit's sensor free from dust.
- Operation can be affected by strong light sources, such as direct sunlight, and the glass doors on cabinets.

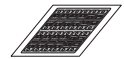

1 Attach the stickers to the speaker cables.



- | | | |
|----------------------------------|-------------------------------------|-------------------------------|
| ① Front speaker (L)
(SB-PF40) | ③ Surround speaker (L)
(SB-PS40) | ⑤ Center speaker
(SB-PC40) |
| ② Front speaker (R)
(SB-PF40) | ④ Surround speaker (R)
(SB-PS40) | ⑥ Subwoofer
(SB-W40) |



About 10 cm (4")

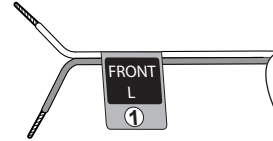

2 Placement of speakers.

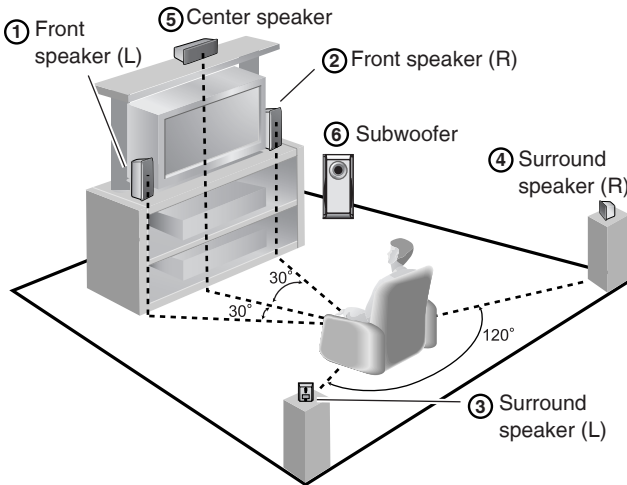

Positioning for best effect

How you set up your speakers can affect the bass and the sound field.

Note the following points.

- Place speakers on flat secure bases.
- Placing speakers too close to floors, walls, and corners can result in excessive bass. Cover walls and windows with a thick curtain.

Note

Keep your speakers at least 10 mm ($13/32$ ") away from the system for proper ventilation.

Place the front, center, and surround speakers at approximately the same distance from the seating position. The angles in the diagram are approximate.

Front speakers (left, right)

Place on the left and right of the TV at seated ear height so that there is good coherency between the picture and sound.

Center speaker

Place underneath or above the center of the TV. Aim the speaker at the seating area.

Surround speakers (left, right)

Place on the side of or slightly behind the seating area, higher than ear level.

Subwoofer

The subwoofer can be placed in any position as long as it is at a reasonable distance from the TV.

Note that some experimentation can yield the smoothest low frequency performance. Placement near a corner can increase the apparent output level, but can result in unnatural bass.

If irregular coloring occurs on your television

The supplied speakers are designed to be used close to a television, but the picture may be affected with some televisions and setup combinations.

If this occurs, turn the television off for about 30 minutes.

The television's demagnetizing function should correct the problem. If it persists, move the speakers further away from the television.



Caution

- The main unit and supplied speakers are only to be used as indicated in this manual. Failure to do so may lead to damage to the receiver and/or the speakers, and may result in the risk of fire. Consult a qualified service person if damage has occurred or if you experience a sudden change in performance.
- Do not attempt to attach these speakers to walls using methods other than those described in this manual.

3 Connect the speakers to the receiver.

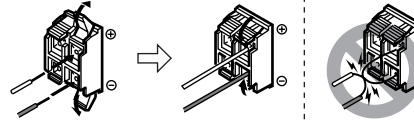
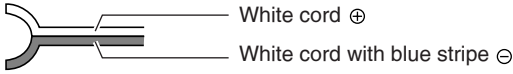

Note
Never short-circuit positive (+) and negative (-) speaker wires.

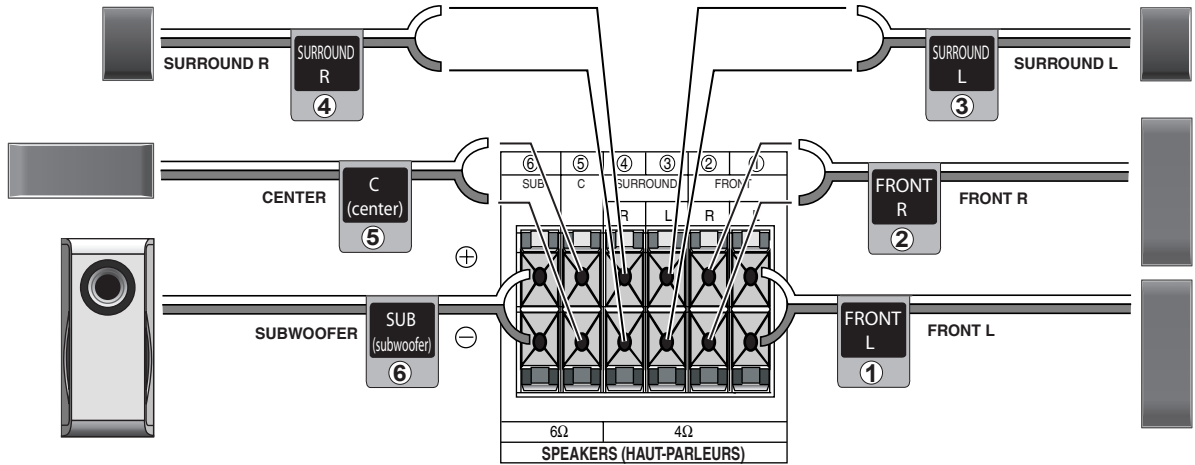

Other speaker setup options

Attaching to a wall

Center speaker

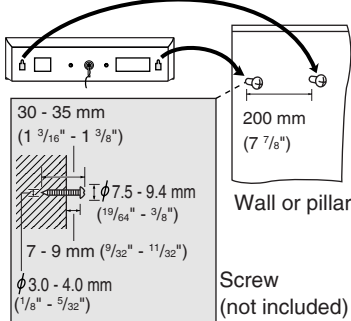

Front speakers

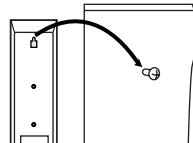

Surround speakers

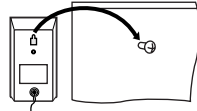

The wall or pillar on which the speakers are to be attached should be capable of supporting 10 kg (22 lb.) per screw. Consult a qualified building contractor when attaching the speakers to wall. Improper attachment may result in damage to the wall and speakers.

Fitting optional speaker stands

e.g. Front speakers

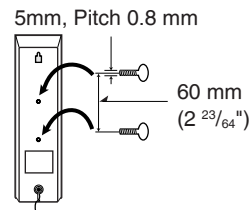

- Use the same distance between the two screws for center speaker.
- Use the same screw type for center and surround speakers.
- The stands must be able to support over 10 kg (22 lb.).
- The stands must be stable even if the speakers are in a high position.

DIGITAL TRANSCEIVER slot

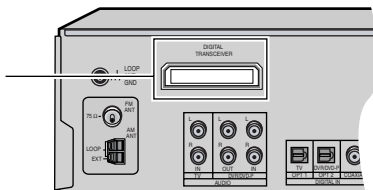

Set your sound free with Panasonic's wireless receiver and speaker systems

Attach the SH-FX60 digital transceiver for wireless surround sound. You can also connect your portable audio equipment to the wireless system.

For details, refer to the operating instructions for SH-FX60.

Step 2

Home theater connections

Other accessories

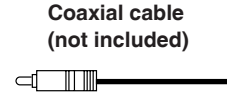
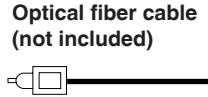
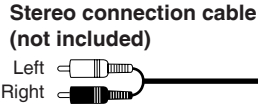

Turn off all components before making any connections.
To connect equipment, refer to the appropriate operating instructions.

Changing the digital input settings

You can change the input settings for the digital terminals if necessary. Note the equipment you have connected to the terminals, then change the settings. One of the terminals will remain unused, whatever the setting. (→ page 8)

Notes on digital input

This unit can decode the following signals:

- Dolby Digital, DTS
- PCM, including PCM with sampling frequencies of 96 or 88.2 kHz

It cannot decode:

- Other digital signals, such as MPEG
- Dolby Digital RF signals from a laser disc player

Note

- Use digital connection to enjoy Dolby Digital or DTS.
- Do not bend the optical fiber cable.

DVR/DVD-P

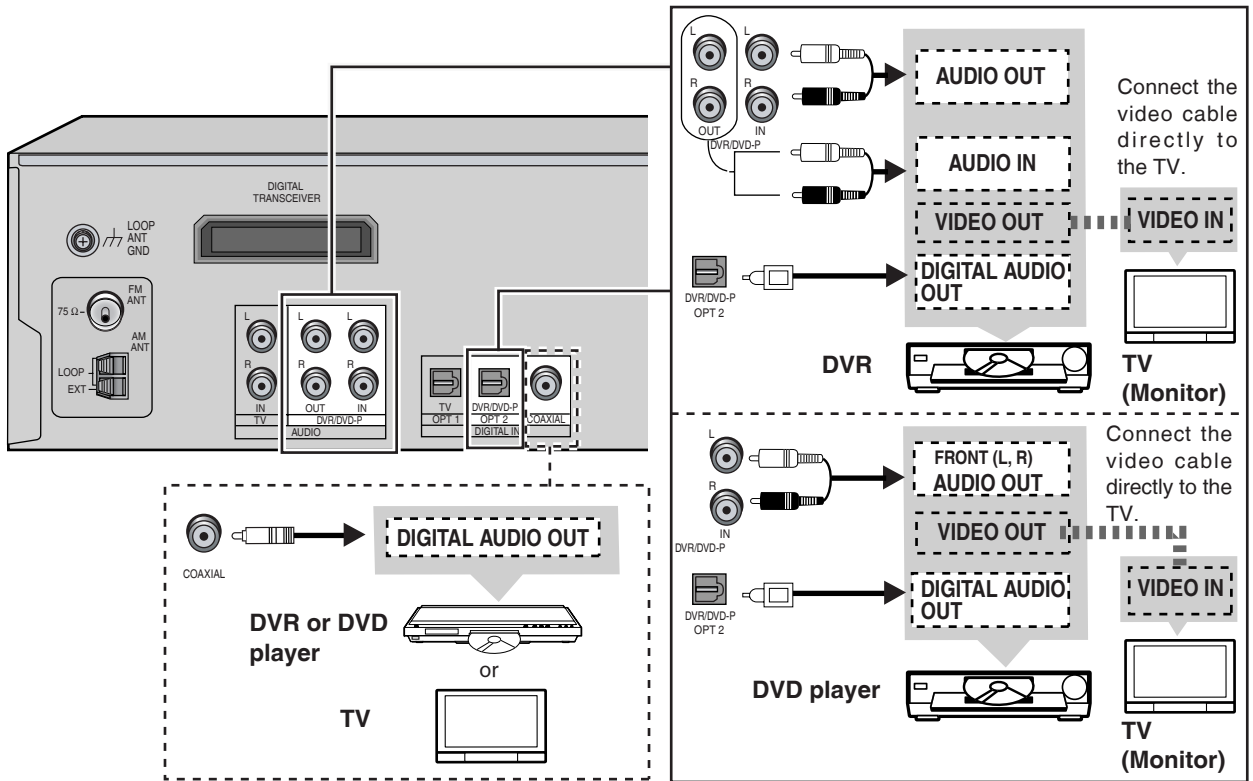

TV (input source)

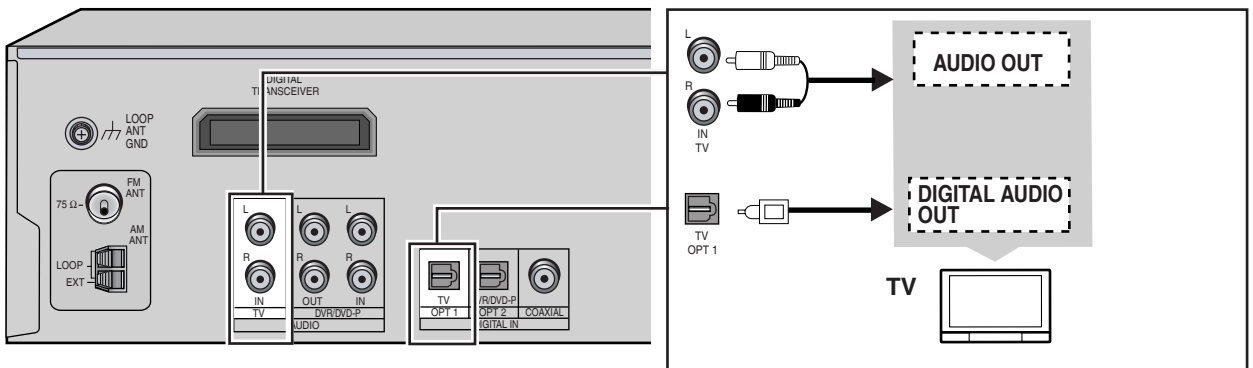

Step 3

Antenna and AC power supply connections

Supplied accessories

AC power supply cord



FM indoor antenna



AM loop antenna



FM indoor antenna (included)

Adhesive tape
Fix the end of the antenna where reception is best.

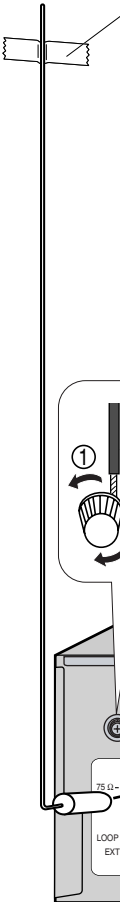

For best reception

FM outdoor antenna (not included)

- Disconnect the FM indoor antenna.
- The antenna should be installed by a competent technician.

FM outdoor antenna

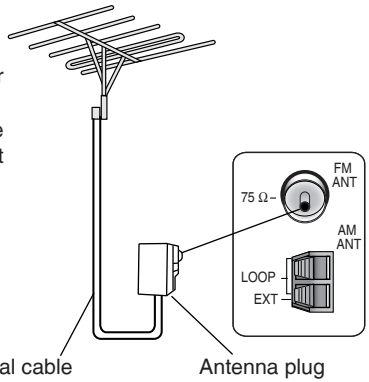

75 Ω coaxial cable

Antenna plug

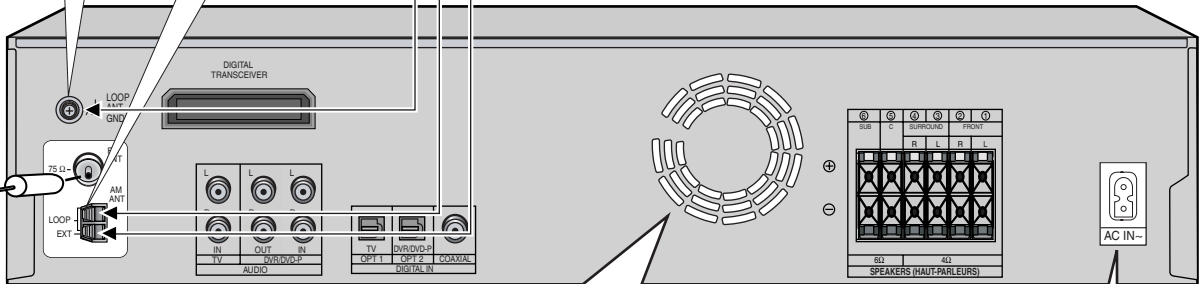
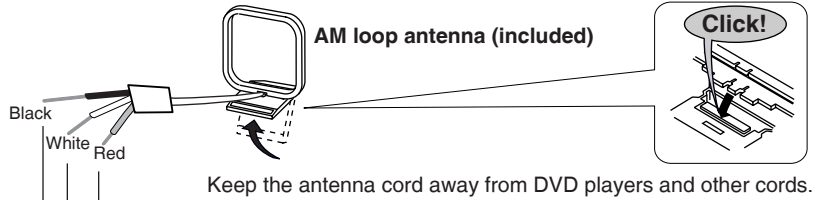
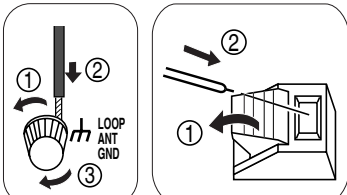

The cooling fan operates at high power output levels only.

AC power supply cord (included)

Connect this cord after all other cables are connected.

Household AC outlet (AC 120 V/60 Hz)

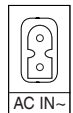

Conserving power

The unit consumes 1 W even when it is turned off with [MUTE/POWER]. To save power when the unit is not to be used for a long time, unplug it from the household AC outlet. You will need to reset some memory items after plugging in the unit.

Note

- The included AC power supply cord is for use with this unit only. Do not use it with other equipment.
- Do not use an AC power supply cord from any other type of equipment with this unit.

Step 4

Settings

Change the settings to suit your equipment to the environment in which you are using it. Before making any changes, read the descriptions of the settings, note the factory settings and ranges, and refer to the equipment's instructions.

DISTANCE

Enter the distance of the front, center and surround speakers from the seating position.

Change the distance so that the sound from all the speakers (except for the subwoofer) reaches you at the same time.

You can select distances between 3 and 30 feet.

The factory settings are:

LR (front):	10 ft (feet)
C (center):	10 ft (feet)
S (surround):	5 ft (feet)

Enter the setup mode.



Press and hold.

Select "DISTANCE".



DIG INPUT (digital input)

Change the digital input settings for TV or DVR/DVD-P to coaxial if your equipment doesn't have an optical output terminal. (One of the terminals will remain unused, whatever the setting.)

The factory settings are:

TV:	OPT1
DVR (DVR/DVD-P):	OPT2

Select "DIG INPUT".



Adjusting speaker output level

C (center), SR (surround right) and SL (surround left) can be adjusted between -10 dB and +10 dB, with 0 dB being the level of the front speakers. Adjust center and surround output to the same apparent level of the front speakers.

For SUBW (subwoofer), you can select "SUBW - -" so there is no output, "SUBW MIN" for minimum output, a level between 1 and 19, or "SUBW MAX" for maximum output. Adjust subwoofer output so it is balanced with the front speakers.

Subwoofer output is easily influenced by the source. You can also change its level while playing something for better effect (➔ page 16).

Output the signal.

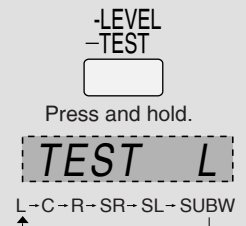

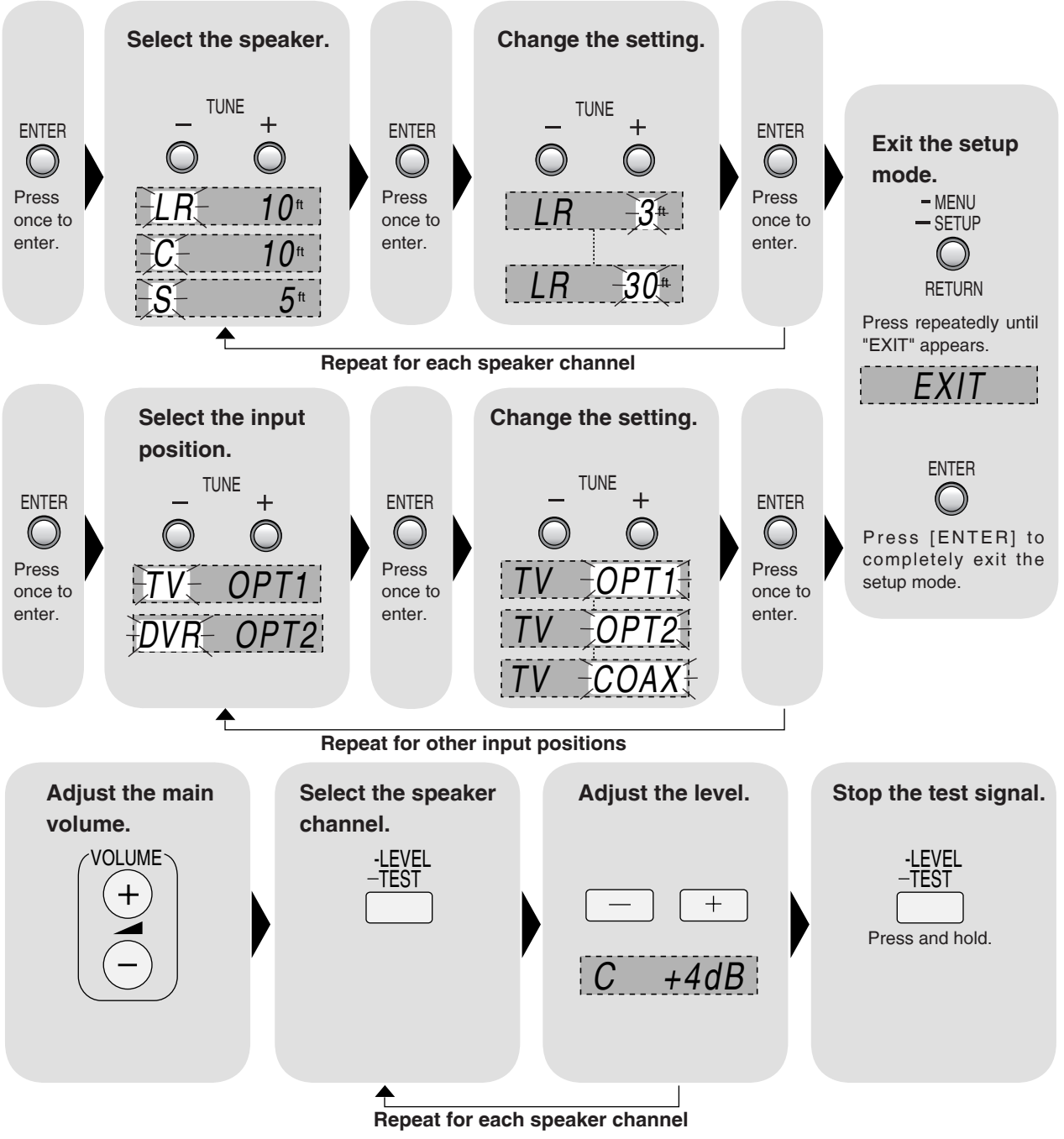
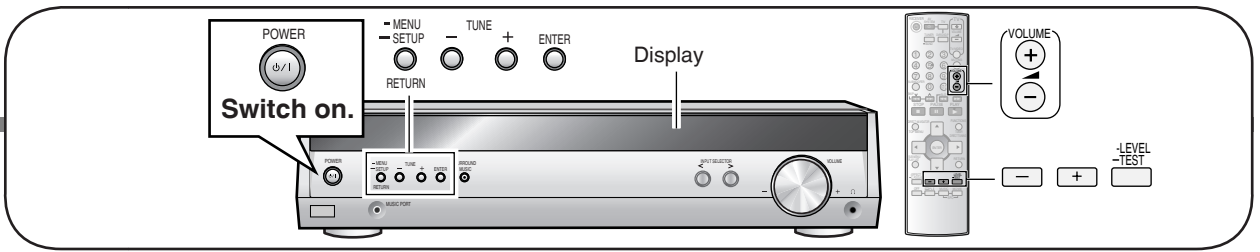

Basic operations

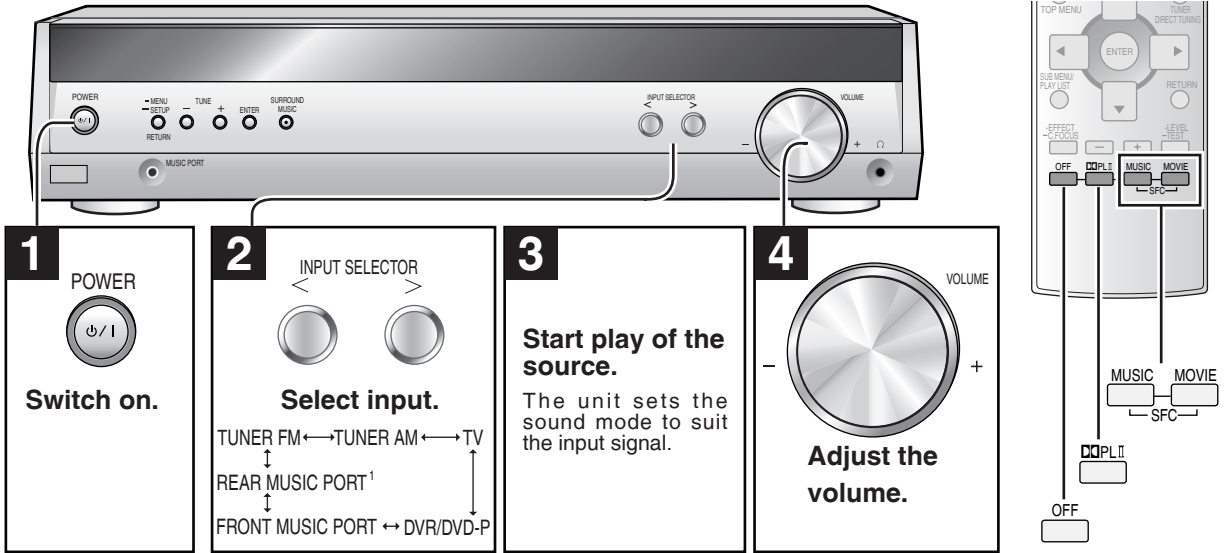

¹Select "REAR MUSIC PORT" to play sound from portable audio equipment connected directly to the wireless system. (➔ page 5)

Adding surround effects to stereo sources

Using Dolby Pro LogicII

Dolby Pro LogicII processor works not only on sources recorded with Dolby Surround, but also on any stereo source.

Press to select a mode from the table at right.

- To cancel, press [OFF].
- You can make fine surround settings when in the MUSIC or PANORAMA mode. (➔ page 16)

	MOVIE Use this mode when playing movie software recorded in Dolby Surround.
	MUSIC Adds surround effects to stereo sources.
	PANORAMA Sound is spread out more so you feel like you are surrounded by music.

Using the Sound Field Control (SFC)

Enjoy an enhanced sound experience with greater presence and spread by using these SFC modes with PCM or analog stereo sources.

Press to select a mode from the tables at right.

- To cancel, press [OFF].
- You can adjust SFC effects. (➔ page 17)

	LIVE Brings you up close for "live" stage performance and smoother vocals.
	POP/ROCK For pop, rock, and other music that has a punch to it.
	VOCAL For adding gloss to vocals.
	JAZZ Conveys the exciting and intimate atmosphere of a jazz club.
	DANCE For dance music and other sounds with a strong beat.
	PARTY This mode uses the front and surround speakers so that sound is in stereo regardless of the direction you are facing.

Note

- Dolby Pro LogicII and SFC modes remain in effect until you turn the mode off.
- When input is PCM with sampling frequencies of 96 or 88.2 kHz, you cannot add surround effects with Dolby Pro LogicII or SFC.
- When input is Dolby Digital or DTS, you cannot use SFC.
- When input is "REAR MUSIC PORT", Dolby Pro LogicII and SFC do not work.

	DRAMA For dramas and other material where dialog is important.
	ACTION For action movies and other material where impact is important.
	SPORTS To make you feel like you were in the stadium.
	MUSICAL For musicals and other material where music is important.
	GAME Enjoy gaming with more impact.
	MONO For monaural sound.

Control guide

Remote control

This page describes the buttons used to control this unit.
See the guide starting page 19 for the buttons that control other units.

[⏻, RECEIVER]
Standby/on button.

[TUNER, -BAND]
For switching the remote control to TUNER mode and selecting TUNER.
After selecting TUNER, press and hold to switch between FM and AM.

[1, 2, 3, 4, 5, 6, 7, 8, 9, 0]
To enter radio frequencies and channels.

[≥10]
To enter two digit channels.

[SUBWOOFER]
For selecting subwoofer level.

[◀◀, ∇, ▶▶, ▲, SKIP]
For selecting preset radio channels.

[-EFFECT, -C.FOCUS]
Use when adjusting Dolby Pro LogicII or SFC effects.
Press and hold to select center focus mode.

[-, +]
First select [-EFFECT] or [-LEVEL, -TEST], then press [-] or [+] to adjust.

[-LEVEL, -TEST]
Use when adjusting speaker level.
Press and hold to start the speaker test signal.

[TV] [DVR/DVD-P]
Input mode and remote control mode buttons.

[MUTING]
To mute the volume.

[+, -, VOLUME]
To adjust the volume.

[TUNER DIRECT TUNING]
To enable selection of radio stations by frequency.

[OFF]
To cancel Dolby Pro LogicII, SFC, and SURROUND MUSIC.

[PLII]
For selecting a Dolby Pro LogicII mode: MOVIE, MUSIC or PANORAMA.

[MUSIC]
For selecting SFC modes: LIVE, POP/ROCK, VOCAL, JAZZ, DANCE or PARTY.

[MOVIE]
For selecting SFC modes: DRAMA, ACTION, SPORTS, MUSICAL, GAME or MONO.

Control guide

Main unit

[, POWER]

Press to switch the unit from on to standby mode or vice versa. In standby mode, the unit is still consuming a small amount of power.

[-MENU, -SETUP, RETURN]

- For entering menus to make various settings.
- For returning to previous menus.

[TUNE, -, +]

For tuning the radio and selecting menu or setup items.

[ENTER]

Used during menu or setup operations.

Remote control signal sensor

[MUSIC PORT]

- You can playback sound from portable audio equipment.
- Reduce the volume to minimum before connecting and disconnecting the equipment.
- Use an audio cord for connection.

[SURROUND MUSIC]

- For turning on the surround music mode (⇒ page 16).

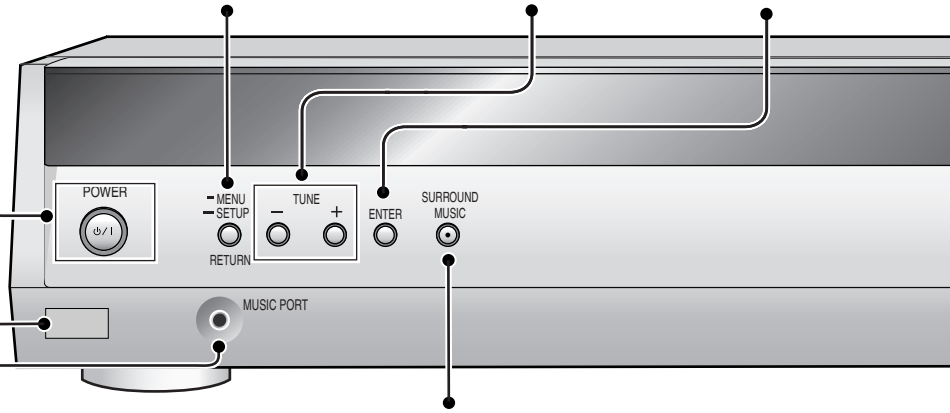

Display

[TUNED, ST, MONO]

Radio indicators

TUNED: A station is tuned

ST: A stereo FM broadcast is tuned

MONO: You have switched to monaural mode to improve reception

[W]

- Lights when you are using the digital transceiver (⇒ page 5).
- Flashes when there is no link between the main unit and the wireless system (For details, refer to the operating instructions for SH-FX60).

[SLEEP]

Sleep timer indicator.

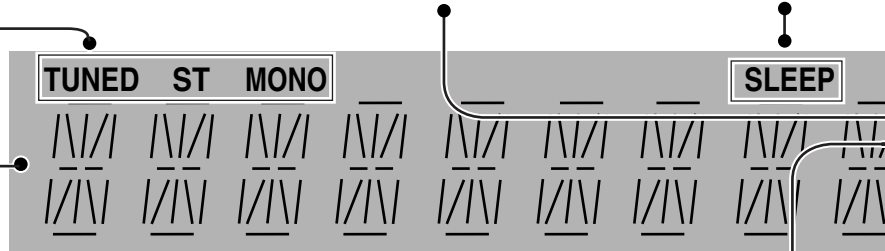

General display

Shows the input mode, radio frequency and other general information.

[ft, kHz, MHz]

Distance and frequency unit indicators

ft: feet (speaker distance)

kHz: AM, or PCM sampling frequency

MHz: FM

[M]

Flashes or lights during automatic presetting.

Making a recording

[INPUT SELECTOR, <, >]
For selecting input.

[VOLUME]
Volume control.

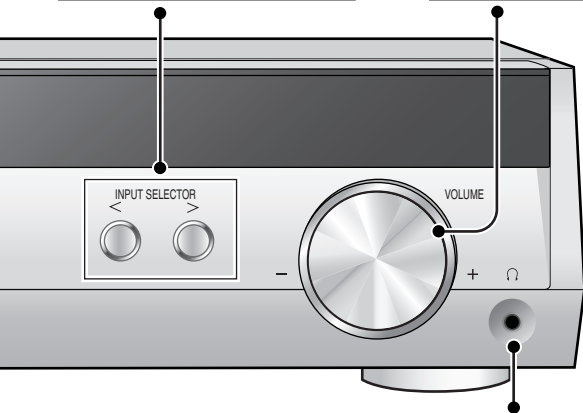

[⌚]
Headphone jack
Plug type: 3.5 mm (1/8") stereo

- Sound does not come from the speakers if you connect headphones.
- Avoid listening for prolonged periods of time to prevent hearing damage.

[PCM, C. FOCUS]
PCM: Lights when the PCM FIX mode is set
C.FOCUS: Appears when you are using Center Focus

[DIGITAL INPUT]
Lights when input is digital.

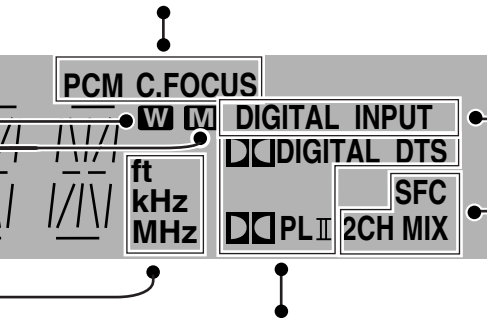

[DIGITAL, DTS, PL II]
Lights to indicate the source's input signal and decoding format used.
DIGITAL: Dolby Digital sources
DTS: DTS sources
PL II: Dolby Pro LogicII decoder is being used

[SFC, 2CH MIX]
SFC: Appears when you are using an SFC mode
2CH MIX: Appears when you are listening to a multi-channel source with headphones

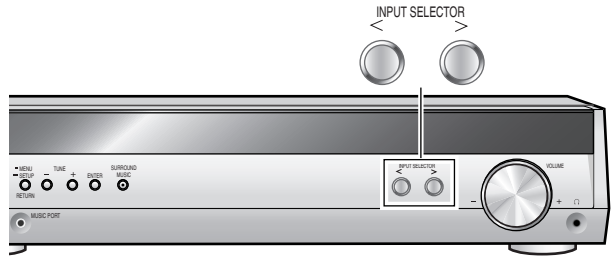

You can record to a unit connected to DVR/DVD-P OUT.
You can record any analog source except DVR/DVD-P IN.

1. Press **[INPUT SELECTOR < or >]** to select the source to be recorded.
2. **Begin recording.**
Follow your recording unit's operating instructions.
3. **Start the source to be recorded.**

Note

This unit cannot record digital sources. Connect through the analog terminals and select "ANALOG" input (→ page 18).

The RESET function

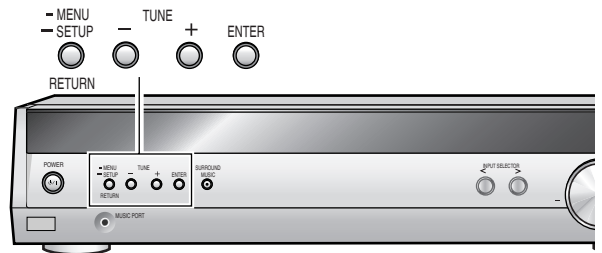

The operation settings for the unit will be initialized to the settings made at the time of shipment.
However, any preset radio stations will not be erased.

1. Press and hold **[-SETUP]** to enter the setup menu.
2. Press **[TUNE - or +]** to select "RESET" → **[ENTER]**.
3. Press **[TUNE +]** to select "RESET YES" → **[ENTER]**.
To cancel, select "RESET NO".

Manufactured under license from Dolby Laboratories.
"Dolby", "Pro Logic" and the double-D symbol are trademarks of Dolby Laboratories.

"DTS" and "DTS Digital Surround" are registered trademarks of Digital Theater Systems, Inc.

MENU operation

This is an outline of the operations you can perform with the MENU.

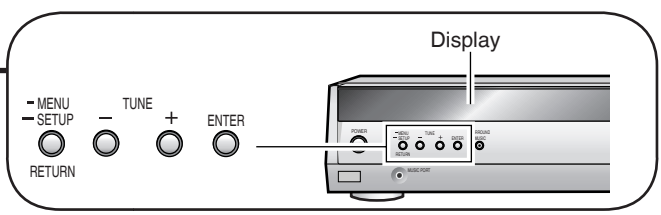

1 Press [-MENU] once.

2 Main menu	3 Sub menu 1	4 Sub menu 2	5 Exit
<p>TUNE - + ENTER</p> <p>TUNER</p> <p>The radio → page 15</p>	<p>TUNE - + ENTER</p> <p>FM MODE</p> <p>(TUNER FM only)</p> <p>MEMORY</p> <p>AUTO MEMO</p> <p>TUNE MODE</p> <p>BEAT PROOF</p> <p>(TUNER AM only)</p>	<p>TUNE - + ENTER</p> <p>AUTO</p> <p>MONO</p> <p>MEMO CH 1</p> <p>MEMO CH30</p> <p>CANCEL</p> <p>START</p> <p>MANUAL</p> <p>PRESET</p> <p>MODE 1</p> <p>MODE 2</p>	<p>-MENU -SETUP RETURN ENTER</p> <p>Press repeatedly until "EXIT" appears.</p> <p>EXIT</p> <p>Press [ENTER] to completely exit the menu mode.</p>
<p>BASS 0</p> <p>Adjust the bass → page 16</p>	<p>BASS -10</p> <p>BASS +10</p>		
<p>TREBLE 0</p> <p>Adjust the treble → page 16</p>	<p>TREBLE -10</p> <p>TREBLE +10</p>		
<p>BALANCE</p> <p>You can adjust the balance of the front speakers → page 16</p>	<p>L R</p>		<p>Press repeatedly until "EXIT" appears.</p> <p>EXIT</p> <p>Press [ENTER] to completely exit the menu mode.</p>
<p>DIMMER OFF</p> <p>Dim the display for better viewing in a darkened room → page 17</p>	<p>DIMMER OFF</p> <p>DIMMER 1</p> <p>DIMMER 2</p> <p>DIMMER 3</p>		
<p>SLEEP OFF</p> <p>The SLEEP timer can turn the unit off after a set time → page 17</p>	<p>SLEEP OFF</p> <p>SLEEP 30</p> <p>SLEEP 60</p> <p>SLEEP 90</p> <p>SLEEP 120</p>		

MENU operation

RQTV0105

The radio

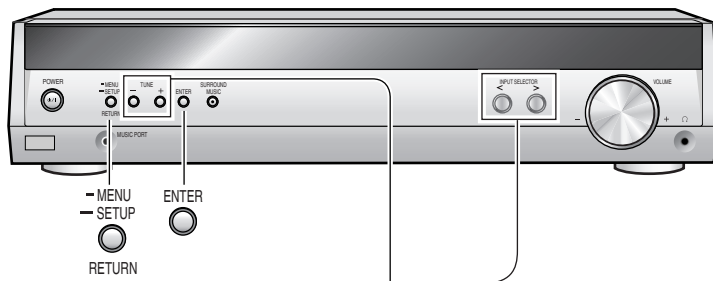
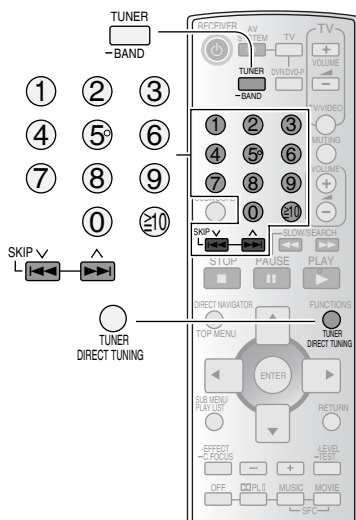

1

INPUT SELECTOR

← →

○ ○

Press [INPUT SELECTOR < or >] to select "TUNER FM" or "TUNER AM".

2

TUNE

- +

○ ○

Select the frequency.
Auto tuning starts if you press and hold the button.

Direct tuning

Input the frequency of the station.

Remote control

1. Press [TUNER, -BAND] to select "TUNER".
2. Press and hold [TUNER, -BAND] to select "TUNER FM" or "TUNER AM".
3. Press [TUNER DIRECT TUNING].
4. Press the numbered buttons to enter the frequency.

e.g. To select 107.9 MHz, press [1] → [0] → [7] → [9]

- If you do not press a button while the cursor is flashing, the display returns to the frequency being received.
- If the frequency has not been input correctly, "ERROR" will be displayed.

Automatic presetting

The FM stations the unit can receive are preset in channels 1 to 30. The AM stations the unit can receive are preset in channels 21 to 30 (FM stations are replaced if any were preset in these channels).

Preparation: Tune to either FM 87.9 MHz or AM 530 kHz.

Main unit

1. Press [-MENU] to select "TUNER" → "AUTO MEMO".
2. Press [TUNE - or +] to select "START" → [ENTER]. Select "CANCEL" to cancel.

The tuner presets all the stations it can receive into the channels in ascending order.

During automatic presetting, the memory indicator (M) flashes and the frequency scrolls. The memory indicator and channel numbers are displayed for a second when a station is preset.

The last station to be preset is displayed when presetting finishes.

Reducing excessive noise

■ During FM stereo reception

You can improve FM reception by switching reception to monaural.

Main unit

1. Press [-MENU] to select "TUNER" → "FM MODE".
2. Press [TUNE - or +] to select "MONO" → [ENTER]. Select "AUTO" to cancel.

Manual presetting

Preset the stations one at a time.

Preparation: Tune to the station you want to preset.

Main unit

1. Press [-MENU] to select "TUNER" → "MEMORY".
2. Press [TUNE - or +] to select the channel → [ENTER]. ("STORED" lights.)

For your reference

FM stations can also be preset in the MONO mode.

Selecting channels

Remote control

1. Press [TUNER, -BAND] to select "TUNER".
2. Press [SKIP ∨ or ∧].

or

Press the numbered buttons.

For channels 1 to 9, press the corresponding number.

For channels 10 or over, press [≥10], then the two digits.

e.g. To select channel 21: [≥10] → [2] → [1]

Main unit

1. Press [-MENU] to select "TUNER" → "TUNE MODE".
2. Press [TUNE - or +] to select "PRESET" → [ENTER]. Select "MANUAL" to cancel.
3. **After exiting the menu:**
Press [TUNE - or +].

■ During AM reception

When there is a lot of noise interference with an AM broadcast, try switching this mode.

Main unit

1. Press [-MENU] to select "TUNER" → "BEAT PROOF".
2. Press [TUNE - or +] to select "MODE 1" or "MODE 2" → [ENTER].

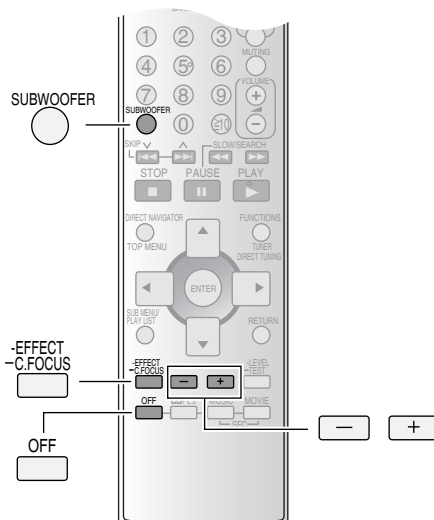
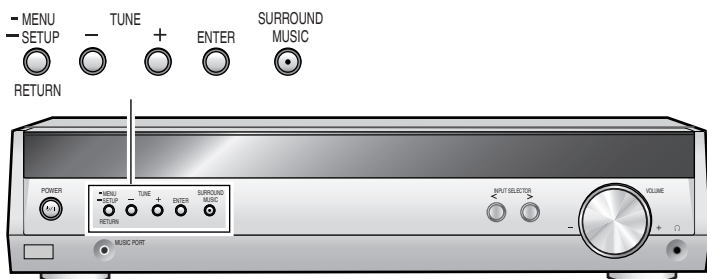

Adjusting the tone

You can adjust the level of the bass and treble.

Main unit

1. Use the menus to select "BASS" or "TREBLE".
➔ MENU operation on page 14.
2. Press [-] or [+] to adjust the tone.

Input signals must be either analog or PCM, and Dolby Pro LogicII and SFC must be off (➔ page 10).

Balance

You can adjust the balance of the front speakers.

Main unit

1. Use the menus to select "BALANCE".
➔ MENU operation on page 14.
2. Press [-] or [+] to adjust the balance.

Subwoofer level

Remote control

Press [SUBWOOFER].

Adjust the level in 5 steps:

SUBW MIN, SUBW 5, SUBW 10, SUBW 15 and SUBW MAX.

Select "SUBW - - -" to stop output.

Note

Sound can be distorted if you raise the volume while subwoofer level is high. Reduce subwoofer level if this occurs.

Surround music

This mode outputs the same sound to all the speakers so that you hear the same sound wherever you are in the room. Use it when the speakers and listeners are spread out.

Main unit

Press [SURROUND MUSIC].

The button lights.

To cancel, press [SURROUND MUSIC] again or press [OFF] on the remote control.

Note

The mode cancels if you connect headphones.

You cannot use this when input is "REAR MUSIC PORT".

The effect will not be as good with some multi-channel sound sources, so turn it off if this is the case.

Dimension Control "DIMEN"

You can adjust the effect of the Dolby Pro LogicII MUSIC and PANORAMA modes (➔ page 10).

You can make up for differences in the output level of the front and surround speakers.

You can choose a level between -3 and +3: Increase the level to move sound to the front speakers, decrease to move it to the surround speakers.

The default level is 0.

Remote control

1. Press [-EFFECT, -C.FOCUS] to select "DIMEN".
2. Press [-] or [+] to adjust the effect.

Center Width Control "C-WDTH"

You can adjust the effect of the Dolby Pro LogicII MUSIC and PANORAMA modes (➔ page 10).

This adjustment helps you realize a more natural sound image when listening to music. Move sound out into the front speakers to improve the overall front image, or add sound to the center speaker to fix the center image.

You can choose a level between 0 (the center speaker is dominant) and 7 (center sound is spread out).

The default level is 3.

Remote control

1. Press [-EFFECT, -C.FOCUS] to select "C-WDTH".
2. Press [-] or [+] to adjust the effect.

Other functions

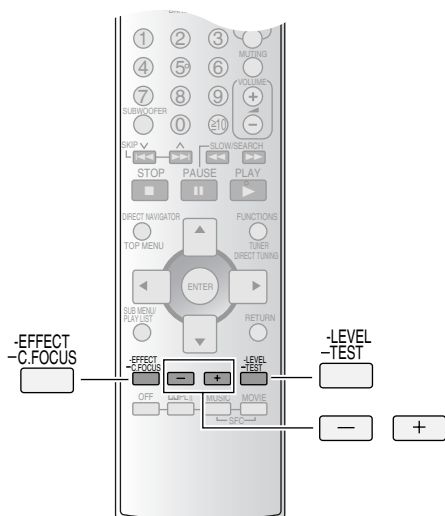

Center focus

Use with discs where the dialogue is recorded in the center channel.

You can make the sound of the center speaker seem like it is coming from within the television.

Remote control

Press and hold [-EFFECT, -C.FOCUS].

"C.FOCUS" lights.

The factory setting is off.

You cannot use this when the sound mode is STEREO or SURROUND MUSIC.

Adjusting SFC effects

You can adjust the sound field by adjusting the level of the speakers and the delay time of the surround speakers. These adjustments can be made for each SFC mode.

To adjust the speaker level

Remote control

1. Press [-LEVEL, -TEST] to select the speaker channel.

Each time you press the button:

C → SR → SL → SUBW

↑

2. Press [-] or [+] to adjust the level.

C, SR, and SL: -10 dB to +10 dB

SUBW: - - - (off) ↔ MIN ↔ 1 - 19 ↔ MAX

To adjust the delay time

Remote control

1. Press [-EFFECT, -C.FOCUS].
2. Press [-] or [+] to change the delay time.
The default setting is 50 mSEC. (10 mSEC - 100 mSEC)

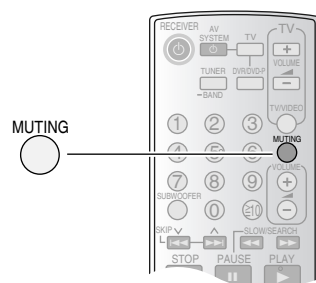

Sleep timer

The SLEEP timer can turn the unit off after a set time. It does not control any other components.

Main unit

1. Use the menus to select "SLEEP".
→ MENU operation on page 14.
2. Press [-] or [+] to select the time (in minutes).
The display changes as follows:
SLEEP OFF ↔ SLEEP 30 ↔ SLEEP 60 ↔ SLEEP 90 ↔ SLEEP 120

To check the setting

1. Press [-MENU] to enter the main menu.
2. Press [TUNE - or +] to select "SLEEP".
The time remaining appears.

To change the setting

Repeat the procedure from the beginning.

Dimmer

Dim the display for better viewing in a darkened room.

Main unit

1. Use the menus to select "DIMMER".
→ MENU operation on page 14.
2. Press [-] or [+] to select the level (1, 2, or 3) or OFF.

Muting

Remote control

Press [MUTING].

To cancel

Press [MUTING] again.

Muting also cancels when you switch the unit to standby.

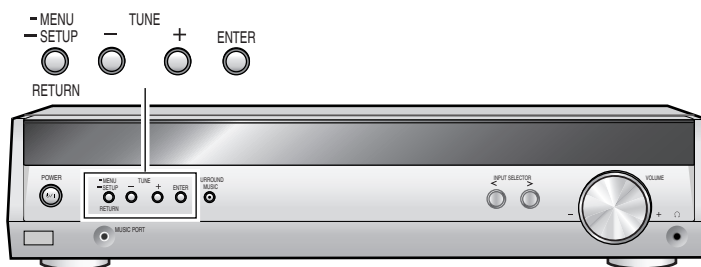

Setting descriptions

A INPUT MODE (Input mode)

This unit automatically detects whether input is digital or analog, but you can fix the input mode.

AUTO: The unit automatically detects whether input is digital or analog.

ANALOG: Select to make the unit accept analog input.

DIG: Select to make the unit accept digital input.

PCMFIX¹: Select to input to PCM.

B DRCOMP (Dynamic range compression)

Change this setting to listen to software recorded with Dolby Digital at low volume (such as late at night) and maintain audio clarity. It reduces the peak level in loud scenes without affecting the sound field.

OFF:

The software is played with the original dynamic range (factory setting).

STANDARD:

The level recommended by the producer of the software for household viewing.

MAX:

The maximum allowable compression (recommended for night viewing).

C ATTENUATOR (A/D Attenuator)

Turn the A/D attenuator on if "OVERFLOW" lights frequently when using 2-channel analog input.

D DTS-PCM

If you are playing a DTS CD that contains both DTS and PCM, but it isn't playing properly, then select "YES".

If this causes noise to occur, return the setting to "NO". (This setting is effective for each digital source.)

Changing the settings

1. Press and hold [-SETUP] to enter the setup menu.
2. Press [TUNE - or +] to select the item you want to change ⇒ [ENTER].
3. Change the settings.

A INPUT MODE

1. Press [TUNE - or +] to select "TV" or "DVR" ⇒ [ENTER].

2. Press [TUNE - or +] to change the setting.

The display changes as follows:

AUTO ↔ ANALOG ↔ DIG ↔ PCMFIX

B DRCOMP

Press [TUNE - or +] to select "OFF", "STANDARD" or "MAX".

C ATTENUATOR

Press [TUNE - or +] to select "OFF" or "ON".

D DTS-PCM

Press [TUNE - or +] to select "NO" or "YES".

4. Press [RETURN] repeatedly until "EXIT" appears ⇒ [ENTER].

¹In rare cases, the unit may have trouble recognizing PCM signals and this may cause the beginnings of tracks to be cut off. Select "PCMFIX" if this occurs.

- With DTS, the signals may not be recognized at all. Engage the DTS FIX mode if this occurs.

To engage the DTS FIX mode:

Press and hold [-MENU] and [ENTER] at the same time.

"DTS" lights.

To cancel the DTS FIX mode:

Press and hold [-MENU] and [ENTER] at the same time.

The mode cancels when input mode is set to AUTO or when the unit is turned off.

Note

When a FIX mode is on, the unit cannot process other signals. This may cause noise to be output. If this occurs, select an input mode other than PCMFIX, or cancel the DTS FIX mode.

Remote control operation guide

This remote control can operate Panasonic DVD recorders, DVD players, and televisions.

Note that this remote control cannot operate some equipment and that it may not be able to perform some operations.

DVD

Before using a Panasonic DVD recorder or player

DVD recorder

Change the remote control code to match the remote control code of the DVD recorder.

1. Check the remote control code of the DVD recorder.
2. For about one second hold down both [ENTER] and the numbered button ([1], [2] or [3]) (the same as the remote control code of the DVD recorder).

The factory setting is [1].

DVD player

Change the remote control code so you can operate a DVD player.

For about one second hold down both [ENTER] and [4].

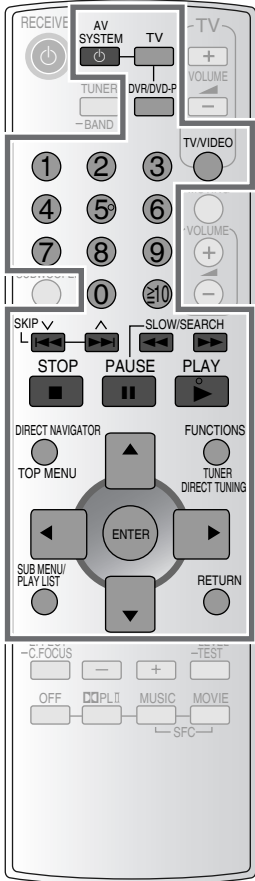

Watching DVDs

Switch on

TV → AV SYSTEM → TV/VIDEO

Switch on the television and select input

DVR/DVD-P → AV SYSTEM → PLAY

Switch on the player and start play

Switch off

DVR/DVD-P → AV SYSTEM → TV → AV SYSTEM

Operating the DVD recorder/DVD player

DIRECT NAVIGATOR TOP MENU → Show disc menus

Start play from a selected item

1 2 3
4 5 6
7 8 9
0 EJECT

SKIP L → Skip items during play

SLOW/SEARCH → Search through the disc

FUNCTIONS TUNER DIRECT TUNING → Show player menus

SELECT and ENTER → Select and enter menu items

RETURN → Clear menus or return to previous menus

PAUSE → SLOW/SEARCH → Start slow-motion play

STOP → Stop play

PAUSE → Pause play

PAUSE → Left Arrow → Right Arrow → To view frame-by-frame

Remote control operation guide

TV

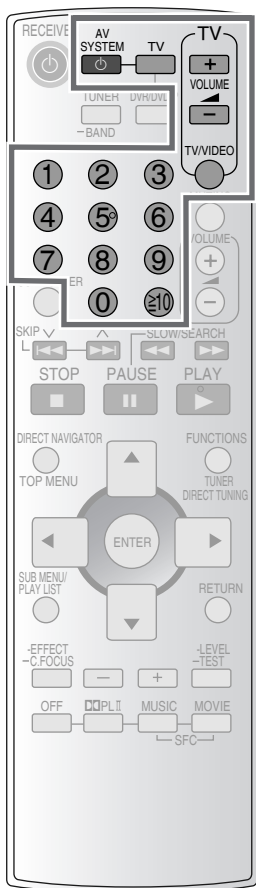

Watching TV

Switch on

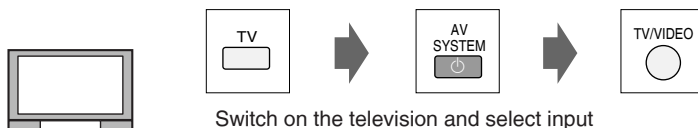

Switch on the television and select input

Switch off



Operating the TV

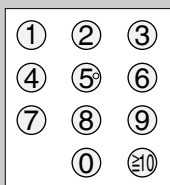

Select channels directly

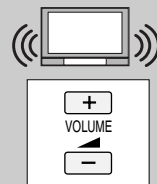

Adjust the volume

Product Service

1. Damage requiring service — The unit should be serviced by qualified service personnel if:

- (a) The AC power supply cord or the plug has been damaged; or
- (b) Objects or liquids have gotten into the unit; or
- (c) The unit has been exposed to rain; or
- (d) The unit does not operate normally or exhibits a marked change in performance; or
- (e) The unit has been dropped or the cabinet damaged.

2. Servicing — Do not attempt to service the unit beyond that described in these operating instructions. Refer all other servicing to authorized servicing personnel.

3. Replacement parts — When parts need replacing ensure the servicer uses parts specified by the manufacturer or parts that have the same characteristics as the original parts. Unauthorized substitutes may result in fire, electric shock, or other hazards.

4. Safety check — After repairs or service, ask the servicer to perform safety checks to confirm that the unit is in proper working condition.

The servicer will require all components to service your system. Therefore, should service ever be necessary, be sure to bring the entire system.

Product information

For product information or assistance with product operation:

In the U.S.A., refer to the "Customer Services Directory" on page 22.

In Canada, contact the Panasonic Canada Inc. Customer Care Centre at 905-624-5505, or visit the website (www.panasonic.ca), or an authorized Servicentre closest to you.

User memo:

DATE OF PURCHASE _____
 DEALER NAME _____
 DEALER ADDRESS _____
 TELEPHONE NUMBER _____

The model number and serial number of this product can be found on either the back or the bottom of the unit. Please note them in the space provided below and keep for future reference.

MODEL NUMBER _____ SC-HT40
 SERIAL NUMBER _____

Specifications (IHF'78)

■ AMPLIFIER SECTION

RMS output power of each channel driven	
10 % total harmonic distortion	
1 kHz front CH	90 W per channel (4 Ω)
1 kHz surround CH	90 W per channel (4 Ω)
1 kHz center CH	220 W per channel (6 Ω)
100 Hz subwoofer CH	220 W per channel (6 Ω)
Total RMS output power	800 W
Rated minimum sine wave RMS power output	
1% total harmonic distortion (Dolby Digital mode)	
150 Hz to 20 kHz front CH	50 W per channel (4 Ω)
150 Hz to 20 kHz surround CH	50 W per channel (4 Ω)
150 Hz to 20 kHz center CH	150 W per channel (6 Ω)
45 Hz to 150 Hz subwoofer CH	150 W per channel (6 Ω)
Total FTC output power	400 W
Rated minimum sine wave RMS power output	
1% total harmonic distortion (Stereo mode)	
150 Hz to 20 kHz front CH	50 W per channel (4 Ω)
45 Hz to 150 Hz subwoofer CH	150 W per channel (6 Ω)
Total FTC output power	200 W
Total harmonic distortion	
Half power at 1 kHz (Front CH)	0.2 % (4 Ω)
Input sensitivity	
DVR/DVD-P, TV	450 mV, IHF'66
MUSIC PORT	250 mV, IHF'66
S/N (IHF A)	
DVR/DVD-P, TV, MUSIC PORT	70 dB (85 dB, IHF'66)
Input impedance	
DVR/DVD-P, TV, MUSIC PORT	47 kΩ
Tone controls	
BASS	50 Hz, +10 to -10 dB
TREBLE	20 kHz, +10 to -10 dB

Digital input	OPTICAL	2
	COAXIAL	1

■ FM TUNER SECTION

Frequency range	87.9 MHz to 107.9 MHz
Sensitivity	11.2 dBf (2 μV, IHF '58)
50 dB quieting sensitivity	
MONO	18.3 dBf (4.5 μV, IHF '58)
STEREO	38.3 dBf (45 μV, IHF '58)
Total harmonic distortion	
MONO	0.3%
STEREO	0.4%
S/N	
MONO	71 dB
STEREO	65 dB
Frequency response	20 Hz to 15 kHz, +1 dB, -2 dB
Image rejection at 98 MHz	40 dB
Stereo separation	
1 kHz	40 dB
Antenna terminal	75 Ω (unbalanced)

■ AM TUNER SECTION

Frequency range	530 kHz to 1710 kHz
-----------------	---------------------

■ SPEAKER SECTION

Front speaker (SB-PF40)

Type	1 Way, 1 Speaker, Bass-ref.
Speaker unit	
Full range	6.5 cm (2 1/2") cone type x 1, 4 Ω
Input power (IEC)	90 W (Max)
Output sound pressure level	78 dB/W (1.0 m)
Frequency range	110 Hz to 23 kHz (-16 dB) 120 Hz to 21 kHz (-10 dB)

Dimensions (W x H x D)

92 mm x 270 mm x 95.4 mm (3 5/8" x 10 5/8" x 3 3/4")
0.8 kg (1.8 lb.)

Mass

Surround speaker (SB-PS40)

Type	1 Way, 1 Speaker, Bass-ref.
Speaker unit	
Full range	6.5 cm (2 1/2") cone type x 1, 4 Ω
Input power (IEC)	90 W (Max)
Output sound pressure level	76 dB/W (1.0 m)
Frequency range	110 Hz to 22 kHz (-16 dB) 120 Hz to 21 kHz (-10 dB)

Dimensions (W x H x D)

92 mm x 135 mm x 95.4 mm (3 5/8" x 5 5/8" x 3 3/4")
0.6 kg (1.3 lb.)

Mass

Center speaker (SB-PC40)

Type	1 Way, 2 Speakers, Bass-ref.
Speaker unit	
Full range	6.5 cm (2 1/2") cone type x 2, 6 Ω
Input power (IEC)	220 W (Max)
Output sound pressure level	82 dB/W (1.0 m)
Frequency range	110 Hz to 22 kHz (-16 dB) 120 Hz to 20 kHz (-10 dB)

Dimensions (W x H x D)

270 mm x 92 mm x 95.4 mm (10 5/8" x 3 5/8" x 3 3/4")
1.3 kg (2.9 lb.)

Mass

Passive subwoofer (SB-W40)

Type	1 Way, 1 Speaker, Bass-ref.
Speaker unit (Woofer)	16 cm (6 1/2") cone type, 6 Ω
Input power (IEC)	220 W (Max)
Output sound pressure level	78 dB/W (1.0 m)
Frequency range	31 Hz to 500 Hz (-16 dB) 38 Hz to 400 Hz (-10 dB)

Dimensions (W x H x D)

182 mm x 392 mm x 266 mm (7 3/16" x 15 7/16" x 10 1/2")

Mass

3.7 kg (8.2 lb.)

■ GENERAL

Power supply	AC 120 V, 60 Hz
Power consumption	100 W
Dimensions (W x H x D)	
430 mm x 105 mm x 385 mm (16 15/16" x 4 1/8" x 15 1/32")	
Mass	3.8 kg (8.4 lb.)

Power consumption in standby mode:	1 W
---	-----

Notes:

- Specifications are subject to change without notice. Mass and dimensions are approximate.
- Total harmonic distortion is measured by the digital spectrum analyzer.

Warranty (U.S.A.)

Panasonic Consumer Electronics Company,
Division of Panasonic Corporation of North America
One Panasonic Way Secaucus, New Jersey 07094

Panasonic Puerto Rico, Inc.
Ave. 65 de Infantería, Km. 9.5
San Gabriel Industrial Park, Carolina, Puerto Rico 00985

Panasonic Audio Products Limited Warranty

Limited Warranty Coverage

If your product does not work properly because of a defect in materials or workmanship, Panasonic Consumer Electronics Company or Panasonic Puerto Rico, Inc. (collectively referred to as "the warrantor") will, for the length of the period indicated on the chart below, which starts with the date of original purchase ("warranty period"), at its option either (a) repair your product with new or refurbished parts, or (b) replace it with a new or a refurbished product. The decision to repair or replace will be made by the warrantor.

Product or Part Name	Parts	Labor
Audio Products (except items listed below)	One (1) year	One (1) year
USB Reader-Writer, Personal Computer Card Adapters (in exchange for defective item)	One (1) year	Not Applicable
Accessories: Headphones, Cartridges, Microphones, Adapters	Ninety (90) days	Ninety (90) days
Rechargeable Batteries, DVD-R/-RAM Discs (in exchange for defective item)	Ten (10) days	Not Applicable
SD Memory Cards, Rechargeable Battery Packs (in exchange for defective item)	Ninety (90) days	Not Applicable

During the "Labor" warranty period there will be no charge for labor. During the "Parts" warranty period, there will be no charge for parts. You must carry-in or mail-in your product during the warranty period. If non-rechargeable batteries are included, they are not warranted. This warranty only applies to products purchased and serviced in the United States or Puerto Rico. This warranty is extended only to the original purchaser of a new product which was not sold "as is". A purchase receipt or other proof of the original purchase date is required for warranty service.

Carry-In or Mail-In Service

For Carry-In or Mail-In Service in the United States call 1-800-211-PANA (1-800-211-7262) or visit Panasonic web site: <http://www.panasonic.com> For assistance in Puerto Rico call Panasonic Puerto Rico, Inc. (787)-750-4300 or fax (787)-768-2910.

Limited Warranty Limits And Exclusions

This warranty ONLY COVERS failures due to defects in materials or workmanship, and DOES NOT COVER normal wear and tear or cosmetic damage. The warranty ALSO DOES NOT COVER damages which occurred in shipment, or failures which are caused by products not supplied by the warrantor, or failures which result from accidents, misuse, abuse, neglect, mishandling, misapplication, alteration, faulty installation, set-up adjustments, misadjustment of consumer controls, improper maintenance, power line surge, lightning damage, modification, or commercial use (such as in a hotel, office, restaurant, or other business), rental use of the product, service by anyone other than a Factory Servicenter or other Authorized Servicer, or damage that is attributable to acts of God.

THERE ARE NO EXPRESS WARRANTIES EXCEPT AS LISTED UNDER "LIMITED WARRANTY COVERAGE". THE WARRANTOR IS NOT LIABLE FOR INCIDENTAL OR CONSEQUENTIAL DAMAGES RESULTING FROM THE USE OF THIS PRODUCT, OR ARISING OUT OF ANY BREACH OF THIS WARRANTY.

(As examples, this excludes damages for lost time, travel to and from the servicer, loss of media or images, data or other memory content. The items listed are not exclusive, but are for illustration only.) **ALL EXPRESS AND IMPLIED WARRANTIES, INCLUDING THE WARRANTY OF MERCHANTABILITY, ARE LIMITED TO THE PERIOD OF THE LIMITED WARRANTY.**

Some states do not allow the exclusion or limitation of incidental or consequential damages, or limitations on how long an implied warranty lasts, so the exclusions may not apply to you.

This warranty gives you specific legal rights and you may also have other rights which vary from state to state. If a problem with this product develops during or after the warranty period, you may contact your dealer or Servicenter. If the problem is not handled to your satisfaction, then write to the warrantor's Consumer Affairs Department at the addresses listed for the warrantor.

PARTS AND SERVICE WHICH ARE NOT COVERED BY THIS LIMITED WARRANTY ARE YOUR RESPONSIBILITY.

Customer Services Directory

Obtain Product Information and Operating Assistance; locate your nearest Dealer or Servicenter; purchase Parts and Accessories; or make Customer Service and Literature requests by visiting our Web Site at:

<http://www.panasonic.com/consumersupport>

or, contact us via the web at:

<http://www.panasonic.com/contactinfo>

You may also contact us directly at:

1-800-211-PANA (7262),

Monday-Friday 9 am-9 pm; Saturday-Sunday 10 am-7 pm, EST.

For hearing or speech impaired TTY users, TTY: 1-877-833-8855

Accessory Purchases

Purchase Parts, Accessories and Instruction Books online for all Panasonic Products by visiting our Web Site at:

<http://www.pasc.panasonic.com>

or, send your request by E-mail to:

npcparts@us.panasonic.com

You may also contact us directly at:

1-800-332-5368 (Phone) 1-800-237-9080 (Fax Only) (Monday - Friday 9 am to 8 pm, EST.)

Panasonic Services Company

20421 84th Avenue South, Kent, WA 98032

(We Accept Visa, MasterCard, Discover Card, American Express, and Personal Checks)

For hearing or speech impaired TTY users, TTY: 1-866-605-1277

Service in Puerto Rico

Panasonic Puerto Rico, Inc.

Ave. 65 de Infantería, Km. 9.5, San Gabriel Industrial Park, Carolina, Puerto Rico 00985

Phone (787)750-4300, Fax (787)768-2910

Warranty (Canada)

Panasonic Canada Inc.

PANASONIC/TECHNICS PRODUCT – LIMITED WARRANTY

Panasonic Canada Inc. warrants this product to be free from defects in material and workmanship and agrees to remedy any such defect for a period as stated below from the date of original purchase.

Technics Audio Product	One (1) year, parts and labour
Panasonic Audio & DVD Product	One (1) year, parts and labour
Accessories including rechargeable batteries	Ninety (90) days

In-home Service will be carried out only to locations accessible by roads and within 50 km of an authorized Panasonic service facility.

LIMITATIONS AND EXCLUSIONS

This warranty does not apply to products purchased outside Canada or to any product which has been improperly installed, subjected to usage for which the product was not designed, misused or abused, damaged during shipping, or which has been altered or repaired in any way that affects the reliability or detracts from the performance, nor does it cover any product which is used commercially. Dry cell batteries are also excluded from coverage under this warranty.

This warranty is extended to the original end user purchaser only. A purchase receipt or other proof of date of original purchase is required before warranty service is performed.

THIS EXPRESS, LIMITED WARRANTY IS IN LIEU OF ALL OTHER WARRANTIES, EXPRESS OR IMPLIED, INCLUDING ANY IMPLIED WARRANTIES OF MERCHANTABILITY AND FITNESS FOR A PARTICULAR PURPOSE. IN NO EVENT WILL PANASONIC CANADA INC. BE LIABLE FOR ANY SPECIAL, INDIRECT OR CONSEQUENTIAL DAMAGES.

In certain instances, some jurisdictions do not allow the exclusion or limitation of incidental or consequential damages, or the exclusion of implied warranties, so the above limitations and exclusions may not be applicable.

WARRANTY SERVICE

FOR PRODUCT OPERATION ASSISTANCE, please contact:

Our Customer Care Centre:	Telephone #:	(905) 624-5505
	1-800 #:	1-800-561-5505
	Fax #:	(905) 238-2360
	Email link:	"Contact Us" on www.panasonic.ca

FOR PRODUCT REPAIRS, please locate your nearest Authorized Servicentre at www.panasonic.ca :

Link : "Servicentres™ locator" under "Customer support"

Panasonic Factory Service:

Richmond British Columbia

Panasonic Canada Inc.
12111 Riverside Way
Richmond BC V6W 1K8
Tel: (604) 278-4211
Fax: (604) 278-5627

Mississauga Ontario

Panasonic Canada Inc.
5770 Ambler Drive
Mississauga ON L4W 2T3
Tel: (905) 624-8447
Fax: (905) 238-2418

IF YOU SHIP THE PRODUCT TO A SERVICENTRE

Carefully pack and send prepaid, adequately insured and preferably in the original carton.
Include details of the defect claimed, and proof of date of original purchase.

Troubleshooting guide

Before requesting service, make the below checks. If you are in doubt about some of the check points, or if the remedies indicated in the chart do not solve the problem, refer to the "Customer Services Directory" on page 22 if you reside in the U.S.A., or refer to "Product information" on page 20 if you reside in Canada.

Common problems		Pages
<p>No power.</p> <p>No sound.</p> <p>"OVERLOAD", "F70", or "F76" appears on the display.</p> <p>"FAN LOCK" appears on the display.</p>	<ul style="list-style-type: none"> Ensure the AC power supply cord is connected. 	7
	<ul style="list-style-type: none"> Turn the volume up. Check connections to speakers and other equipment. Select the correct source. 	10 5-7 10
	<ul style="list-style-type: none"> Change the DIG INPUT setting to suit the type of connection you have made. Check that the digital signals can be decoded by this unit. Turn PCMFIX or DTS FIX off. 	8-9 6 18
	<ul style="list-style-type: none"> Turn the unit off, disconnect the AC power supply cord, and consult your dealer. 	-
	<ul style="list-style-type: none"> Remove the object obstructing the cooling fan. 	7

Sound		Pages
<p>Sound is not heard from the center, surround, or subwoofer speakers.</p>	<ul style="list-style-type: none"> The source may be stereo. Use Dolby Pro LogicII or SFC. 	10
<p>A ticking noise interrupts the sound.</p>	<ul style="list-style-type: none"> The speaker wires are touching each other. Check all your speaker connections. 	5
<p>Cannot use Dolby Pro LogicII or SFC.</p>	<ul style="list-style-type: none"> You cannot use Dolby Pro LogicII or SFC when input is PCM with sampling frequencies of 96 or 88.2 kHz. 	10

Radio		Pages
<p>The radio cannot be tuned in or there is a lot of noise and interference.</p> <p>There is a lot of noise when listening to AM.</p>	<ul style="list-style-type: none"> Connect the appropriate antenna. (You may need an outdoor antenna or one with more elements.) Adjust the position of the FM or AM antenna. Reduce the treble. Turn off nearby televisions, video decks and DVD players. Separate the antenna from other cables, leads, and appliances. Try changing the sound mode or turning the modes off. 	7 7 14, 16 - - 10
	<ul style="list-style-type: none"> Try changing the BEAT PROOF mode. 	14, 15

Maintenance

If the surfaces are dirty

To clean this unit, wipe with a soft, dry cloth.

- Never use alcohol, paint thinner or benzine to clean this unit.
- Before using chemically treated cloth, carefully read the instructions that came with the cloth.

Panasonic Consumer Electronics Company, Division of Panasonic Corporation of North America
One Panasonic Way Secaucus,
New Jersey 07094
<http://www.panasonic.com>

Panasonic Puerto Rico, Inc.
Ave. 65 de Infantería, Km. 9.5
San Gabriel Industrial Park, Carolina,
Puerto Rico 00985

Panasonic Canada Inc.
5770 Ambler Drive
Mississauga, Ontario
L4W 2T3
www.panasonic.ca

